

DML-50

DUAL MANUAL TOP DOWN ROLLER SHADE WITH CLUTCH SYSTEM

FEATURES:

- Contemporary and compact roller shade system
- Field upgradable to motorization DMS - 50
- Fabric wrapped fascia available
- Extendable idle

BENEFITS:

- Compact and strong
- Smooth operation
- Simple installation
- Available with DC or Battery Motors
- Extendable idle
- Short bracket
- Small light gaps
- Available as crank operation

SYSTEM INDEX

1. CLUTCH

Available in White, Gray and Black

2. TUBE

- A. 45mm Tube
- B. 49mm Tube

3. SLIMLINE DUAL BRACKET

Available in White, Gray and Black

4. SQUARE DUAL BRACKET

Available in White, Gray and Black

5. IDLER

Available in White, Gray and Black

6. HEMBAR

- A. Sealed Hembar
- B. Exposed w/End Caps
- C. Fabric Wrapped w/End Caps

7. CHAIN HOLD DOWN

Available in White, Gray and Black

8. OPTIONAL FASCIA SYSTEM

9. CHAIN

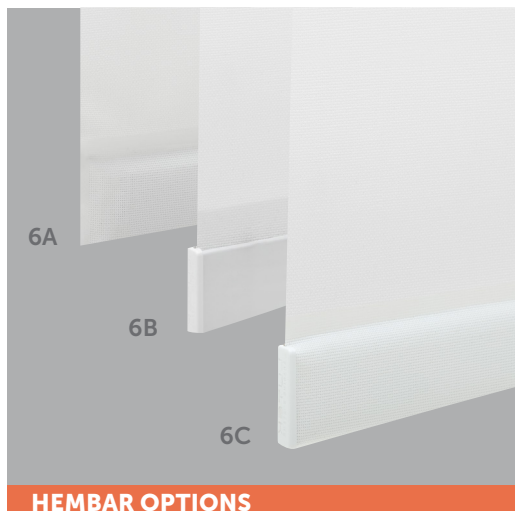
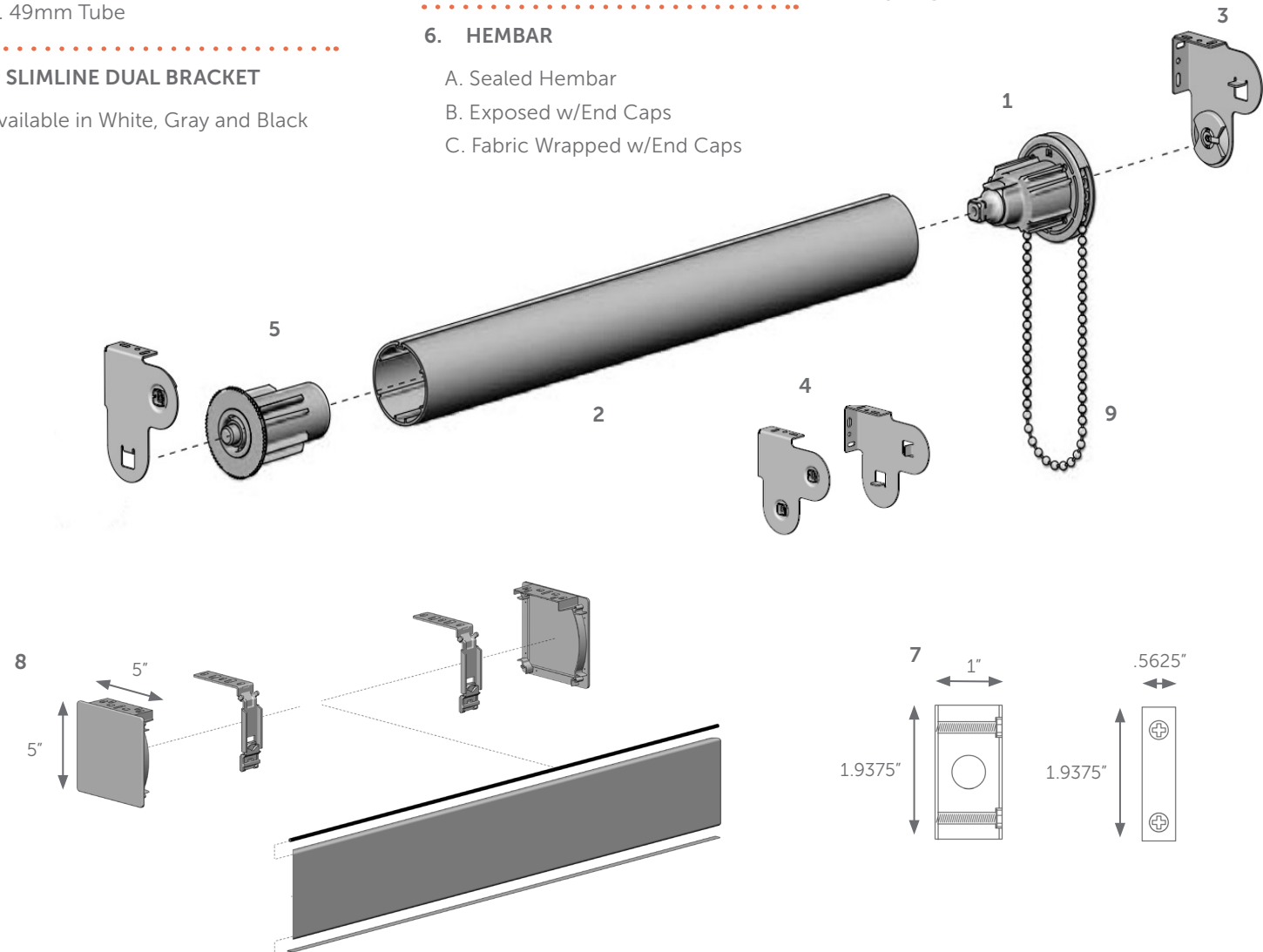

HEMBAR OPTIONS

DML-50

DUAL MANUAL TOP DOWN ROLLER SHADE WITH CLUTCH SYSTEM

SHADE DEDUCTIONS

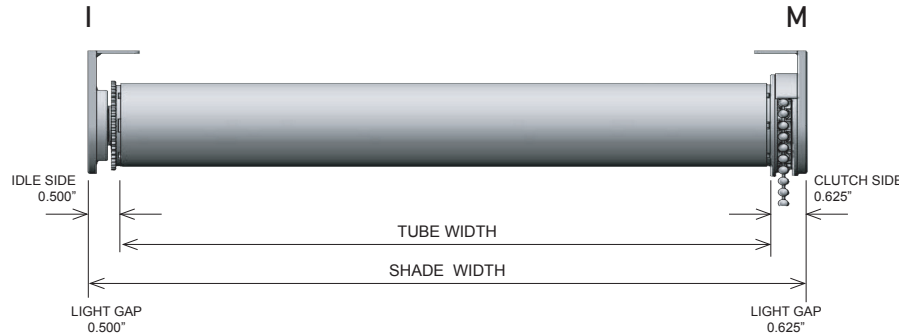

COUPLED SHADE DEDUCTIONS

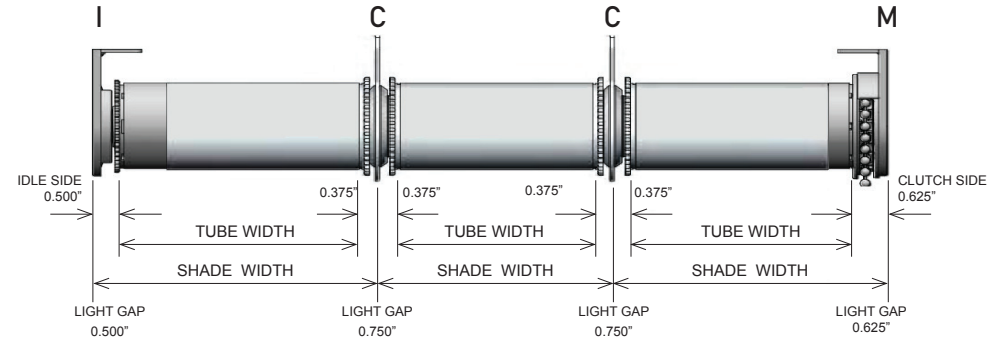

DRIVE	BRACKETS	IDLE SIDE	COUPLER SIDE	CLUTCH SIDE	OVERALL DEDUCTION
M-I	WITH FASCIA END CAPS	0.625" (15.9mm)		0.750" (19.1mm)	1.375" (34.9mm)
	WITHOUT FASCIA END CAPS	0.500" (12.7mm)		0.625" (15.9mm)	1.125" (28.6mm)
I-C	WITH FASCIA END CAPS	0.625" (15.9mm)	0.375" (9.5mm)		1.00" (25.4mm)
	WITHOUT FASCIA END CAPS	0.500" (12.7mm)	0.375" (9.5mm)		0.875" (22.2mm)
C-C	WITH FASCIA END CAPS		0.750" (19.1mm)		0.750" (19.1mm)
	WITHOUT FASCIA END CAPS		0.750" (19.1mm)		0.750" (19.1mm)
M-C	WITH FASCIA END CAPS		0.375" (9.5mm)	0.750" (19.1mm)	1.125" (28.6mm)
	WITHOUT FASCIA END CAPS		0.375" (9.5mm)	0.625" (15.9mm)	1.00" (25.4mm)

DML-50 SYSTEM CAPACITY

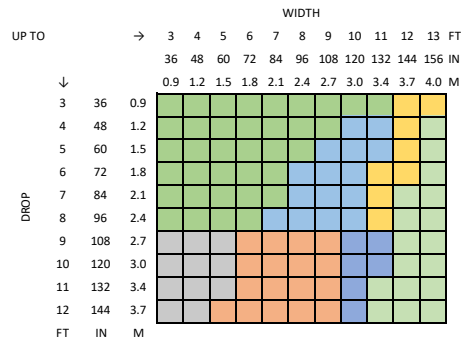

Parameters
 Fabric Weight (oz/sq yd): 13.30
 Fabric Thickness (in): 0.02
 Hembar Weight (oz/ft): 2.75

CONTROL	BRACKET	TUBE
RB07 Clutch	Slimline Bracket	45mm
RB07 Clutch + Spring	Slimline Bracket	45mm
RB07 Clutch + Spring	Slimline Bracket	49mm
RB07 Clutch	Square Bracket	45mm
RB07 Clutch + Spring	Square Bracket	45mm
RB07 Clutch + Spring	Square Bracket	49mm
RB07 Clutch + Spring	Square Bracket	45mm/49mm Square Coupler

Outside Specifications
 *For optimal performance shades need to maintain 4:1 ratio of length to width. Shades can be outside this ratio however shade performance could be impacted
 **Exceeding these values may cause fabric tracking issues
 ***Coupled shades are available for larger widths

MAX ROLL

